



Company Profile

Tong Hwei has grown to be the leading Stainless Steel Fasteners manufacturer in the world. We not only specialize in standard products to the international specifications but also are skillful in the engineered products to blue prints. Our logo "THE" is recognized as the best brand of Stainless Steel Fasteners. We adhere to the spirit of "continuous improvement to meet customer needs", providing customers with a high level support and service to customers through a wide product range along with efficient correspondence, superior quality, reliable delivery performance and competitive pricing.

Our Advantages

Tong Hwei has grown to be the leading Stainless Steel Fasteners manufacturer in the world. We not only specialize in standard products to the international specifications but also are skillful in the engineered products to blue prints. Our logo "THE" is recognized as the best brand of Stainless Steel Fasteners. We adhere to the spirit of "continuous improvement to meet customer needs", providing customers with a high level support and service to customers through a wide product range along with efficient correspondence, superior quality, reliable delivery performance and competitive pricing.



Hex Head Cap Screws / Hex Bolts

Hexagon head cap screws and bolts are used widely. The hexagon head is designed for easy usage, and it performs well in balance between force application and reception. The external appearance of these products is to match and to be used together with the internal parts, for example, nuts, and then to fasten the components.

There are two major thread designs, the course thread (UNC) and the fine thread (UNF), and the course thread part is more commonly used in general. On the other hand, the UNF parts performs good in self-locking, and they are mainly adopted in fastening components which are thicker or harder.

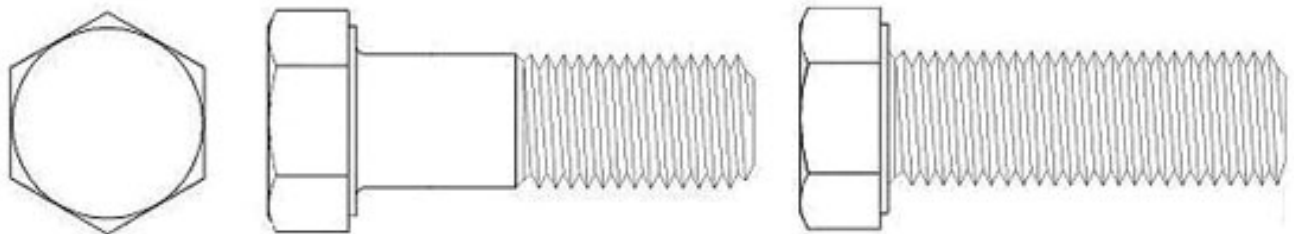

304/316 HEX HEAD CAP SCREWS/HEX BOLTS

Diameter: 1/4" - 1" x Length: up to 12"

DIN 933/ 931 A 2/A4 HEXAGON BOLTS

Diameter: M6 - M24 x Length: up to 300mm



Carriage bolts (Round Head Square Neck Bolts)

The characteristics of the bolt are its round head and the square neck underneath which is formed for the purpose of stop the bolt from rotation. These products are popular used in connecting steel materials, for example, cars, lifeboats, and textile machinery.

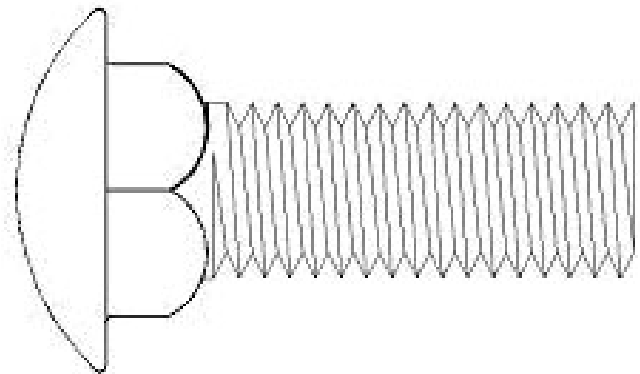
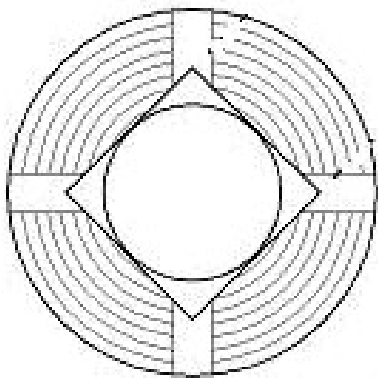

18-8/316 ROUND HEAD SQUARE NECK CARRIAGE BOLTS

Diameter: 1/ 4" - 3/ 4" x Length: up to 12"

DIN 603 A 2/A4 MUSHROOM HEAD SQUARE NECK BOLTS

Diameter: M6 - M20 x Length: up to 300mm



Woodscrews (Lag Screws)

Woodscrews, literally and practically, is used for fastening two or more pieces of woods. The pitches are no such close as hex cap screws, and the product has a sharp end which is shaped for easy drilling.

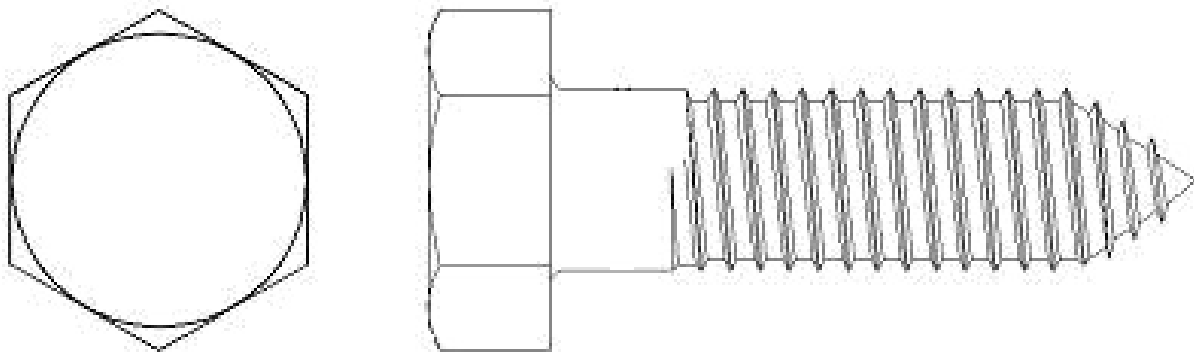

18-8/316 HEX HEAD LAG SCREWS

Diameter: 1/ 4" - 5/ 8 " x Length: up to 8 "

DIN 571 A 2/A4 HEX WOOD SCREWS

Diameter: M6 - M16 x Length: up to 200mm



Hex Socket Head Cap Screws

The usage of hex socket head cap screw is similar to socket flat countersunk head cap screw.

They are characterized with a hex socket which is formed to be easy to fasten and loosen.

These products are mostly used in fastening machinery and its components.

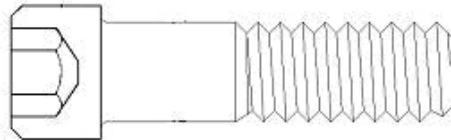
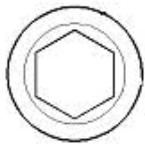

18-8/316 HEX HEAD LAG SCREWS

Diameter: 1/4" - 5/8" x

Length: up to 8"

DIN 571 A 2/A4 HEX WOOD SCREWS

Diameter: M6 - M16 x Length: up to 200mm

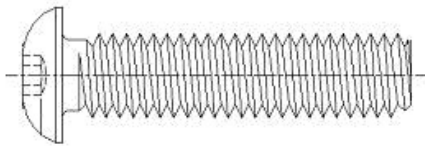
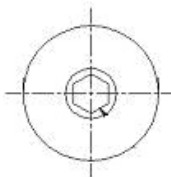

18-8 HEX SOCKET BUTTON HEAD CAP SCREWS

Diameter: 1/4" - 1/2" x Length: up to 6"

A2 DIN 7380 HEX SOCKET BUTTON HEAD CAP SCREWS

Diameter: M6 - M12 x Length: up to 150mm

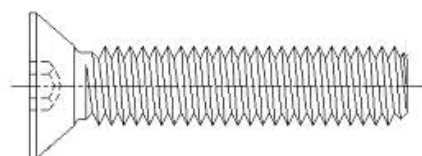
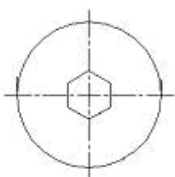

18-8 HEX SOCKET FLAT COUNTERSUNK HEAD SCREWS

Diameter: 1/4" - 1/2" x Length: up to 6"

A2 DIN 7991 HEX SOCKET FLAT COUNTERSUNK HEAD SCREWS

Diameter: M6 - M12 x Length: up to 150mm



Machine Screws

With slotted or recessed head, these products are simple to be locked in and out. These bolts are applied to parts requiring milder locking force.

Machine screws have various shapes of head, flat countersunk head, pan head, oval head, truss head, round head, and fillister head. Users can choose different head shapes for different applications.

Slotted Flat Countersunk Head Machine Screw

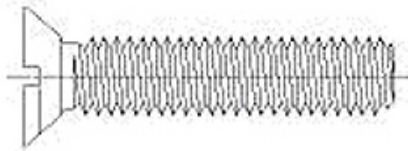

Cross Recessed Flat Countersunk Head Machine Screws

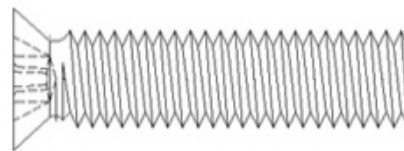

Slotted Truss Head Machine Screw

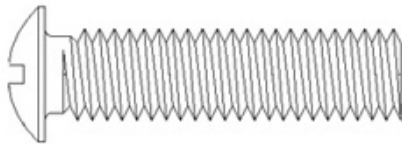

Cross Recessed Truss Head Machine Screws

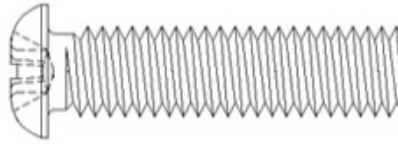

Slotted Round Head Machine Screws

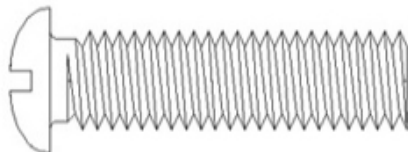

Cross Recessed Round Head Machine Screws

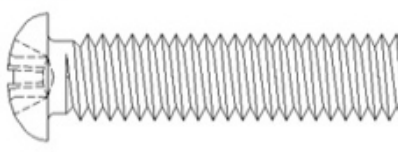

Slotted Pan Head Machine Screws

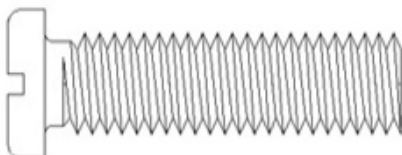

Cross Recessed Oval Head Machine Screws

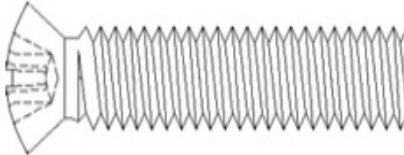

Slotted Fillister Head Machine Screws

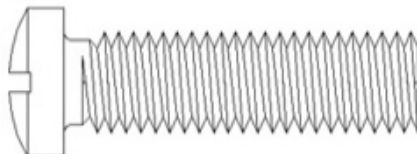

Diameter: 1/4" - 1/2" x Length: up to 6"